

Rising School Rolls

South Morningside Primary School

Crawford McGhie – Asset Planning Manager
Robbie Crockatt – Estate Development Officer

29th September 2014

Overview and context

- Rising rolls process and timescales
- Wider south Edinburgh area
- Interim and long term solution
- Working group
- Long term solution report to Dec 2014
- Interim solution for August 2015
- 2 interim options

South Morningside Primary

- Forecast P1 Intake Limits

	2014	2015	2016	2017	2018	2019	2020
Intake Limit	99	99	90	99	90	90	90

- 22 classes required from August 2015
- **Significant driver for change: Other accommodation issues**

South Morningside Primary

Option 1: New 6 classroom temporary unit



PROPOSED SITE PLAN
DEMOLITIONS/ ENABLING WORKS (PHASE 1)
SCALE 1:500



South Morningside Primary

Option 1: New 6 classroom temporary unit

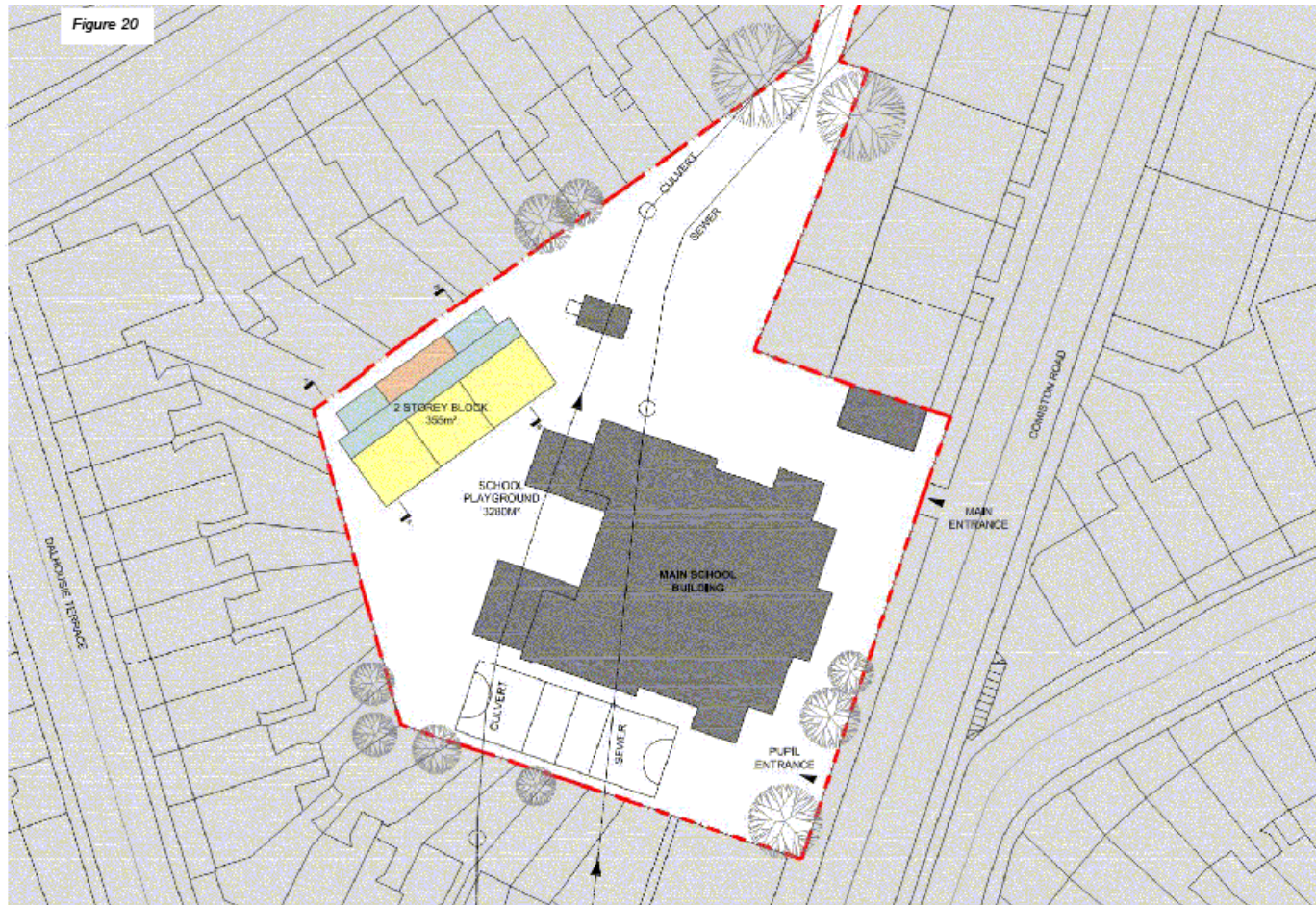

PROPOSED SITE PLAN
TEMPORARY CLASSROOM ANNEXE (PHASE 2)
SCALE 1:500

South Morningside Primary

Option 1: New 6 classroom temporary unit

For

- Removes old temporary units addressing condition issues;
- Addresses requirement for additional class space;
- Provides additional general purpose (GP) space;
- Small increase in play area;
- Opens up playground space;
- Retains large majority of pupils on one site.

Against

- Cluny Centre still required for classes; Fairmilehead for nursery;
- Pressure on facilities (e.g. dining, GP, staff, etc.) remains;
- Decant required during June 2015 to allow demolition of TUs;
- Playground space reduced significantly during June 2015;
- Planning? Cluny Centre availability?

South Morningside Primary

Option 2: P1 and P2 Annexe



South Morningside Primary

Option 2: P1 and P2 Annexe

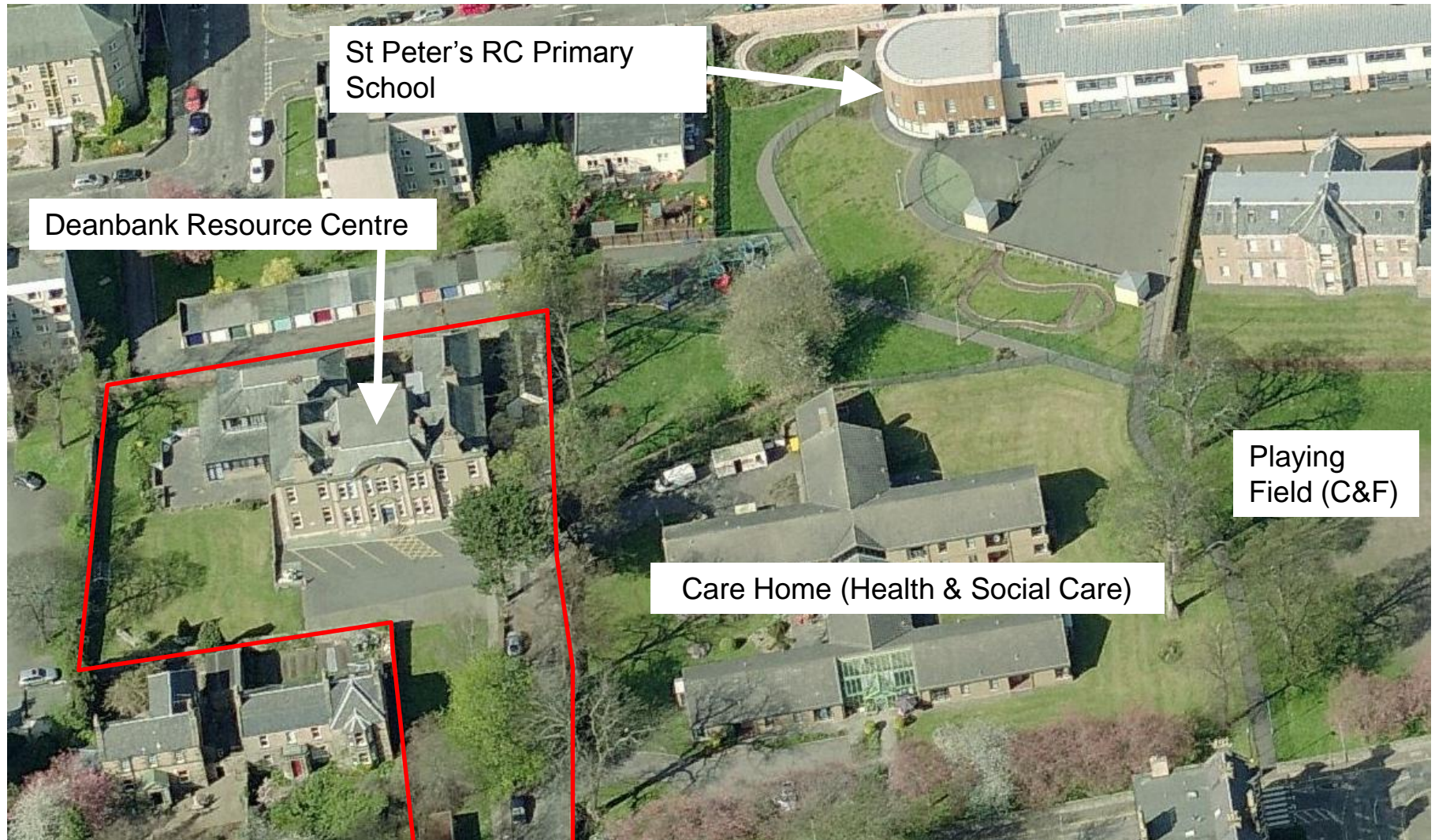

South Morningside Primary

Option 2: P1 and P2 Annexe

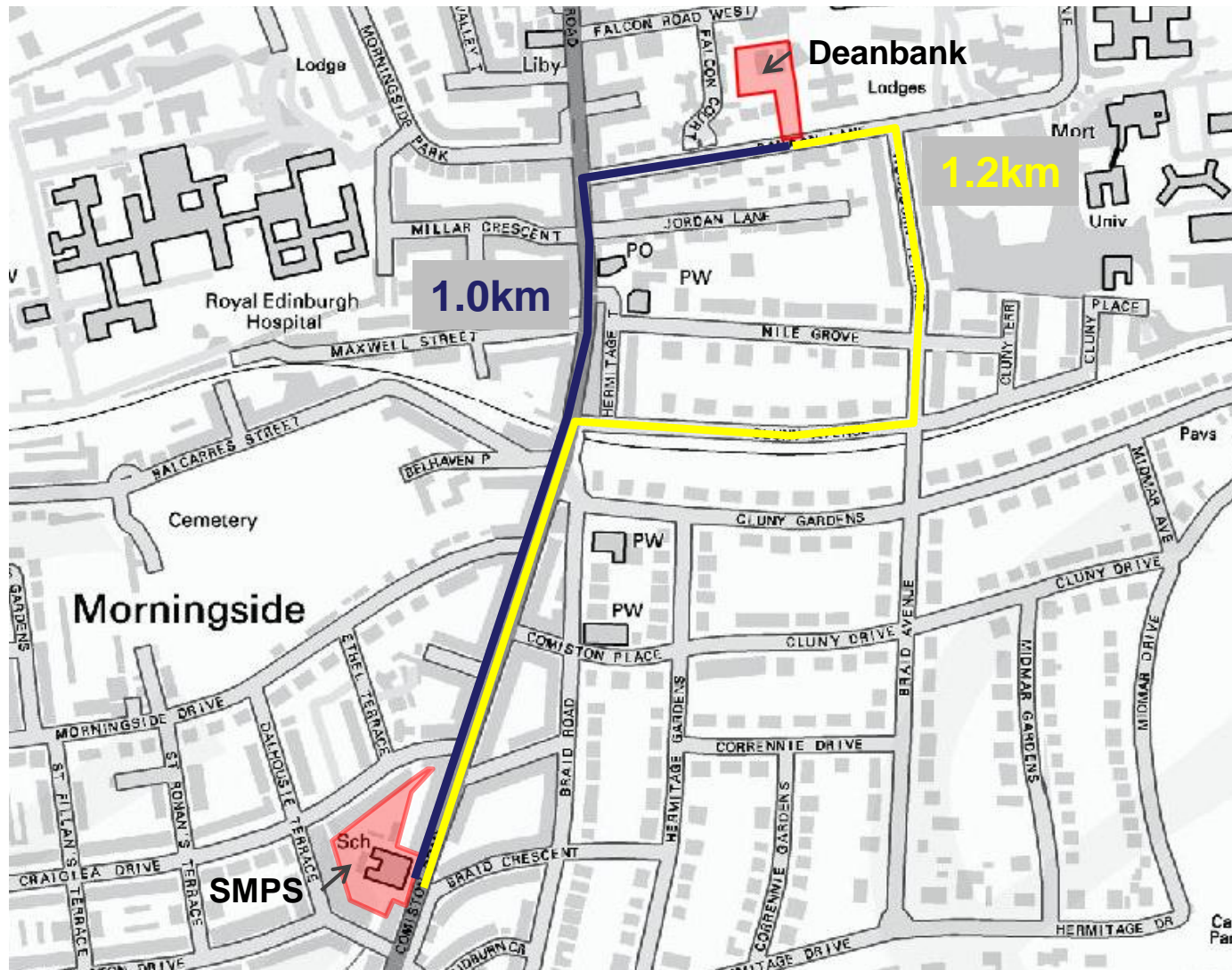

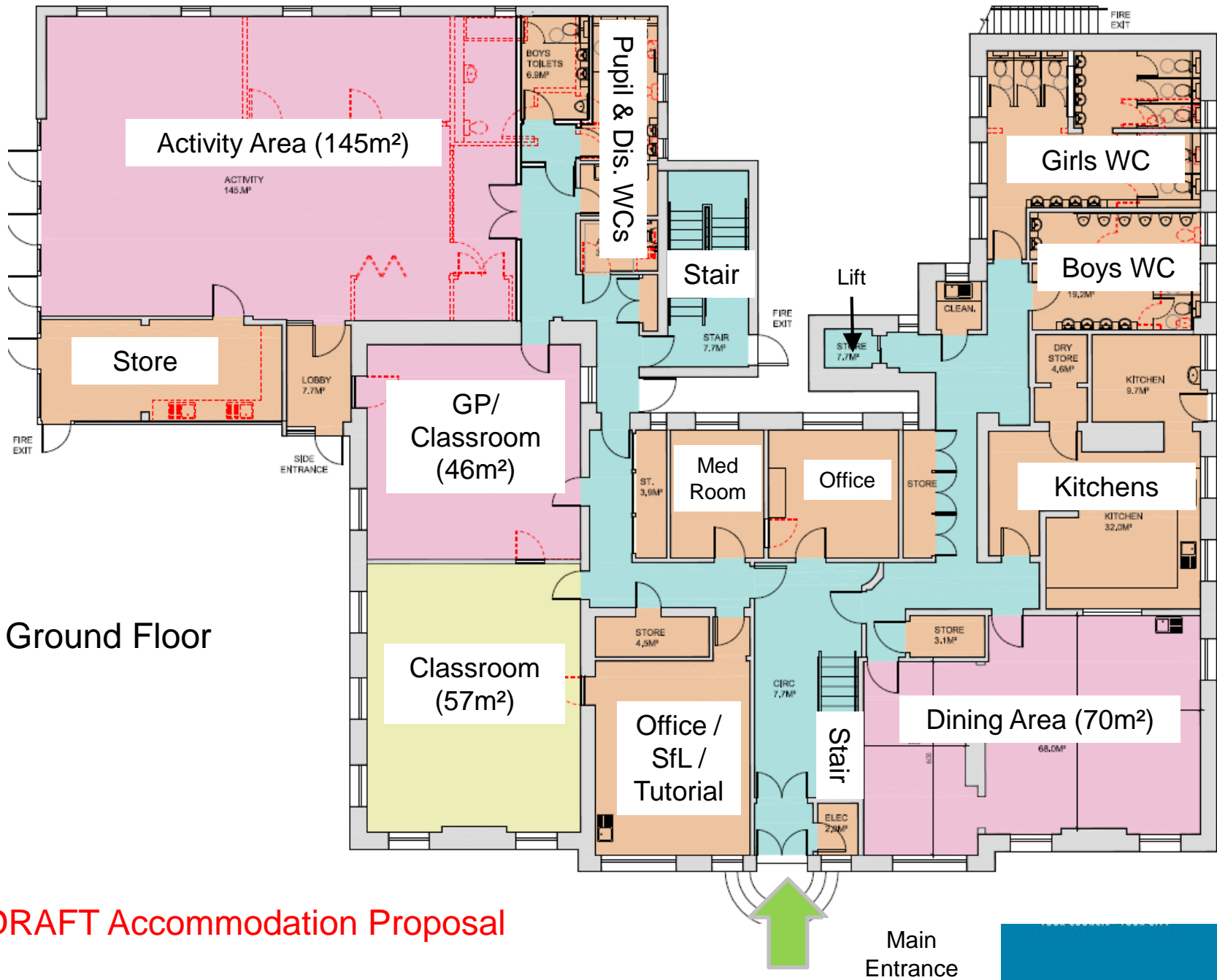

DRAFT Accommodation Proposal

South Morningside Primary

Option 2: P1 and P2 Annexe

For

- Removes all temporary units from main school site;
- Classes no longer required at Cluny Centre;
- Reduced pressure on school facilities (e.g. playground, dining, GP, staff, etc.);
- No decant; no on-site works; no planning requirements;
- Council owned property – school as sole users;
- Lift access; grassed outdoor area;

Against

- School separated over 3 distinct sites;
- Distance: logistical issues for drop-off and school management.

Next Steps

- Feedback from this evening
- Further feedback through parent representatives until October break
- Decision made based on all considerations – e.g. further detail on costs and timescales
- Continued involvement of Working Group
- Delivery of preferred option for August 2015